

**PROPOSED PROJECT AT MOUZA-TARAPUKURIA, J.L. NO-12,  
TOUZI NO-178, R.S. DAG NO-506 & 506/995, R.S. KHATIAN  
NO-996 & 116, HOLDING NO-1/A/2, SURENDRA MOHAN BOSE  
ROAD(LAHA BAGAN), WARD NO-11, UNDER PANIHATI  
MUNICIPALITY, P.S.-KHARDAH, DISTRICT-NORTH 24 PARGANAS**

---

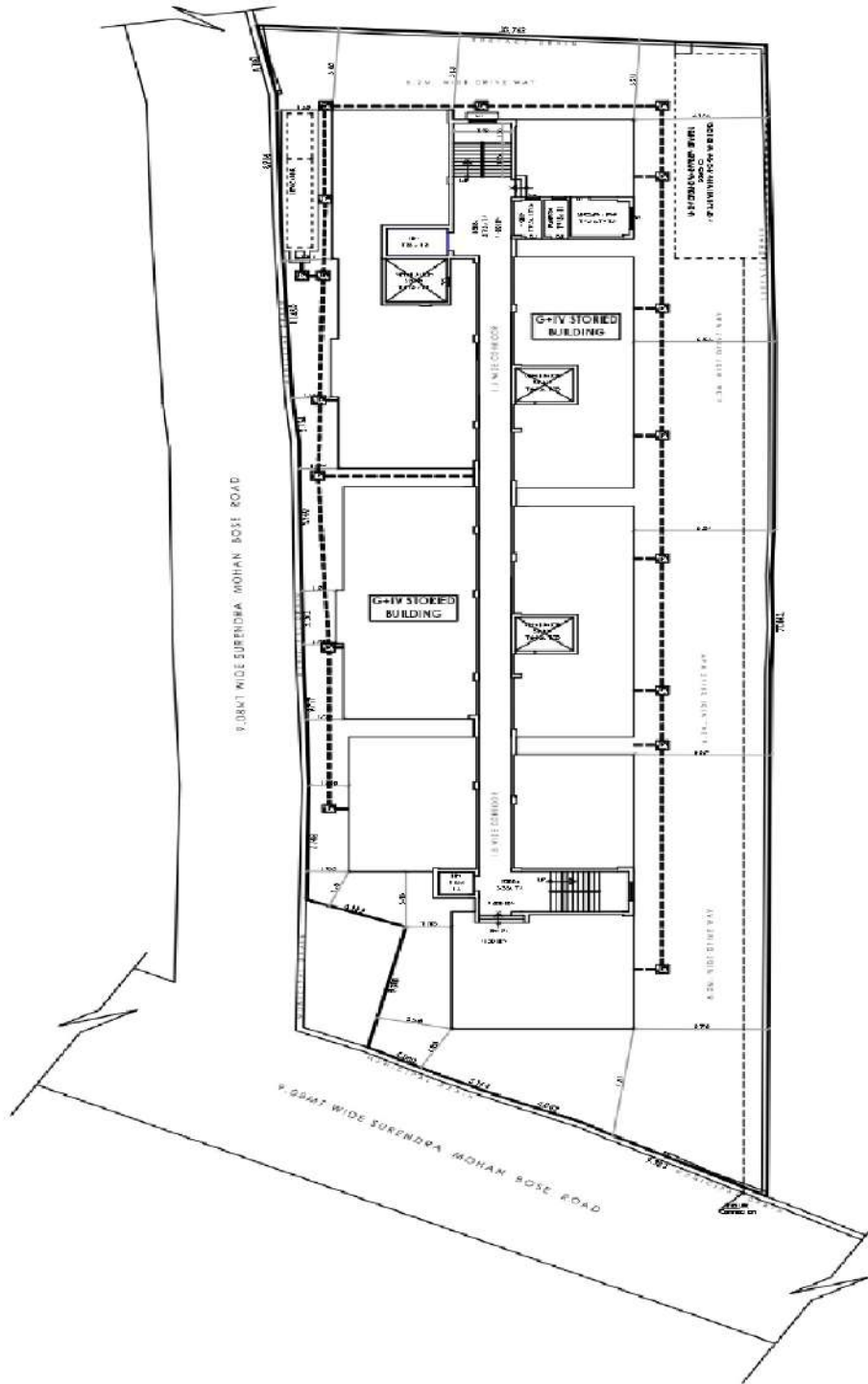

**LATITUDE : 22.524324**  
**LONGITUDE : 88.354206**

For SILVERPEAK REAL ESTATE LLP

*S. K. Kothari*  
Partner

---

**SIGNATURE OF OWNER**